

# MULTI-PURPOSE GRAB

MULTI-PURPOSE GRAB FOR VARIABLE USE AND HANDLING OF DIFFERENT MATERIALS, STONE LAYING, SORTING AND HANDLING OF CONSTRUCTION WASTE, SORTING AND HANDLING OF RECYCLING MATERIAL, EXCAVATION AND LOADING OF ROUGH BULK MATERIAL

## FRD MULTI-PURPOSE GRAB - FMP SMALL SERIES -

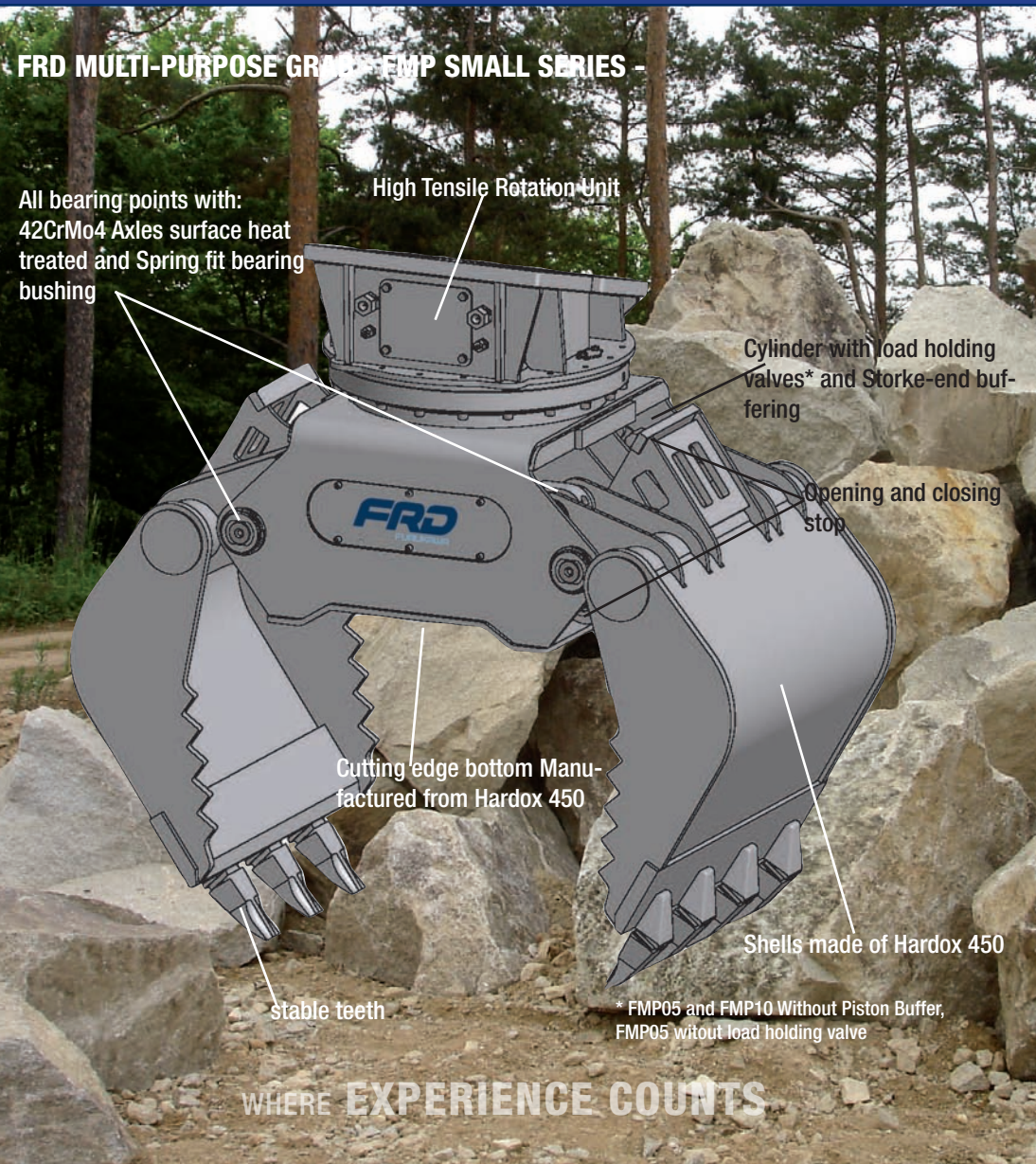

WHERE EXPERIENCE COUNTS

# OUTSTANDING DEALER NETWORK



# WHERE EXPERIENCE COUNTS

"What we mean by service to our clients includes same day repair and part delivery, fast repair on location in the event of a rare break down or immediate replacement machine. We have a great name to uphold. We intend to keep it that way."

### LOCAL SERVICE AND SUPPORT

FRD seeks firstly to supply a product of undoubted integrity. Then back this up with a support network of dedicated dealers to ensure whatever support, wherever and whenever needed. The FRD-dealer combination has been made unbeatable.

FRD dealers have been selected for their professional competence, their market coverage, their dedication to quality and their willingness to work. They receive intense training on all machines and systems and every support that a committed manufacturer can give them. They actively exchange experience between each other to ensure their clients get the latest lessons from the market. They are a skilled and fast team of professionals.

"For a professional problem-free job FRD offers the best combination of quality equipment and instant service and support. The dealer network is outstanding."

### VALUE FOR MONEY

Buying FRD products is a smart investment. A reasonable price for top quality, long lifetime, low maintenance and no break-down-time products in the long term makes financially good sense.

Next steps? FRD Europe and its dealers have a vast resource of information beyond what can be mentioned here. Do not hesitate to get in touch for more detail and an unbeatable quote.

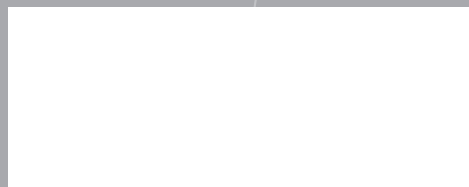

Ribs that are connected with each other and with a through and through one piece Pipe



**Furukawa Rock Drill Europe BV**  
 Proostwetering 29, 3543 AB Utrecht, The Netherlands  
 Phone +31-(0)30-2412277, Fax +31-(0)30-2412305  
 www.frd.eu

# FRD GRAPS



FDG - SERIES  
 FMP - SERIES

DURABLE AND RELIABLE

# WHERE EXPERIENCE COUNTS

# DEMOLITION AND SORTING GRAB

## DURABLE AND RELIABLE

DESIGNED TO DEMOLISH BRICK WALLS, AND SORT AND LOAD ALL KINDS OF DEMOLISHED MATERIALS. CLOSED SHELLS. WITH INTEGRATED LOAD-HOLDING VALVE.

## FRD DEMOLITION AND SORTING GRAB - FDG LARGE SERIES -



WHERE EXPERIENCE COUNTS

# DEMOLITION AND SORTING GRAB



DESIGNED TO DEMOLISH BRICK WALLS, AND SORT AND LOAD ALL KINDS OF DEMOLISHED MATERIALS. CLOSED SHELLS. WITH INTEGRATED LOAD-HOLDING VALVE.



## FRD DEMOLITION AND SORTING GRAB - FDG LARGE SERIES -

## FRD DEMOLITION AND SORTING GRAB - SMALL FDG SERIES -

Demolition- and sorting grab for variable use and handling of different materials, as for example:

- demolition and sorting
- sorting and handling of construction waste
- sorting and handling of recycling material

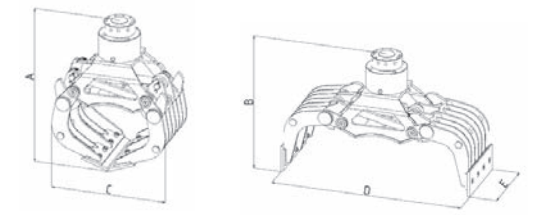

### DESIGN FEATURES

- Compact hydraulic rotator unit with heavy duty axial and radial bearings.
- Flat compact design. Hydraulic cylinders and ganging guidance completely protected inside the frame
- FDG20-PL and FDG30-PL cylinders with limit damping
- FDG10-PL, FDG20-PL and FDG30-PL with self-hold valves at the cylinders. It prevent the unintentional opening of the grab
- Integrated mechanical opening and closing stoppers
- Buckets complete of high strength fine-grain steel ( 400 HB )
- Screw-in exchange knives of high strength fine-grain steel ( 400 HB )
- Grab design for free oscillating use available

		FDG05-PL	FDG10-PL	FDG20-PL	FDG30-PL
Operating weight <sup>1)</sup>	kg	140	220	510	940
Capacity	l	45	80	200	370
Sustainability max.	t	1	1	2	4
Sust.- Rotary Engine max.	t	5	5	10	15
Dimension A	mm	700	820	1075	1205
Dimension B	mm	760	720	950	1070
Dimension C	mm	640	660	940	1170
Dimension D	mm	1000	1105	1630	1925
Width E	mm	360	400	600	800
Closing max.	kN	13	15	36	59
Operating pressure max.	bar	250	250	350	350
Oil flow max.	l/min	30	22	40	60
Oper.- pressure rotator max.	bar	320	250	250	250
Oil flow rotator max.	l/min	20	20	28	48
Base machine weight	t	1-2	3-5	5-9	9-15

Specifications subject to change without notice. <sup>1)</sup> Operating Weight basic unit without turning unit and mounting plate.

WHERE EXPERIENCE COUNTS

### DESIGN FEATURES

- Hydraulic rotator unit with heavy duty axial and radial bearings with rotating annulus rotator
- Flat compact design. Hydraulic cylinders and ganging guidance cpl. protected inside the frame
- With limit damping
- Self-hold valves at the cylinders prevent the unintentional opening of the grab
- Integrated mechanical opening and closing stoppers
- Buckets complete of high strength fine-grain steel ( 400 HB )
- Screw-in exchange knives of high strength fine-grain steel ( 400 HB )
- Grab design for free oscillating use available

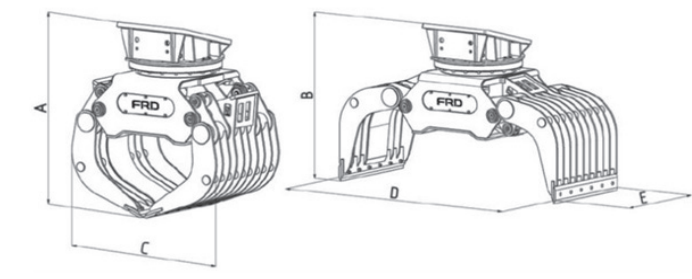

		FDG35-PL	FDG40-PL	FDG50-PL	FDG60-PL
Operating weight <sup>1)</sup>	kg	1080	1540	1785	2220
Capacity	l	370	650	760	925
Sustainability max.	t	4	6	6	8
Sust.- Rotary Engine max.	t	15	20	20	30
Dimension A	mm	1420	1595	1765	1800
Dimension B	mm	1285	1445	1490	1600
Dimension C	mm	1175	1415	1450	1530
Dimension D	mm	1925	2250	2450	2500
Width E	mm	800	900	1000	1230
Closing max.	kN	59	60	75	75
Operating pressure max.	bar	350	350	350	350
Oil flow max.	l/min	60	62	90	112
Oper.- pressure rotator max.	bar	120	140	140	140
Oil flow rotator max.	l/min	30	30	30	30
Base machine weight	t	15-20	20-25	25-30	29-40

Specifications subject to change without notice. <sup>1)</sup> Operating Weight basic unit without turning unit and mounting plate.

WHERE EXPERIENCE COUNTS

# MULTI-PURPOSE GRAB



DESIGNED TO DEMOLISH BRICK WALLS, AND SORT AND LOAD ALL KINDS OF DEMOLISHED MATERIALS. CLOSED SHELLS. WITH INTEGRATED LOAD-HOLDING VALVE.



## FRD MULTI-PURPOSE GRAB - FMP SMALL SERIES -

Multi-purpose grab for variable use and handling of different materials, as for example:

- stone laying
- sorting and handling of construction waste
- sorting and handling of recycling material
- excavation and loading of rough bulk material

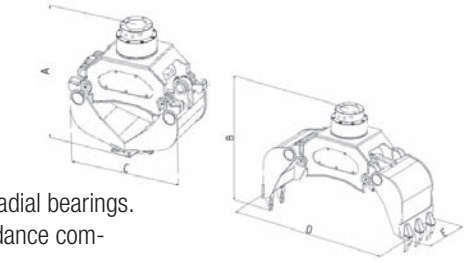

### DESIGN FEATURES

- Compact hydraulic rotator unit with heavy duty axial and radial bearings.
- Flat compact design. Hydraulic cylinders and ganging guidance completely protected inside the frame
- FMP20-PL and FMP30-PL cylinders with limit damping
- FMP10, FMP20-PL and FMP30-PL with self-hold valves at the cylinders. It prevent the unintentional opening of the grab
- Integrated mechanical opening and closing stoppers
- Wear-resistant bottom cutters and side plates of high strength fine-grain steel ( 400 HB )
- FMP05-PL and FMP10-PL with screw-in exchange knives / FMP20-PL and FMP30-PL with ESCO-plug-in exchange knives
- Grab design for free oscillating use available

		FMP05-PL	FMP10-PL	FMP20-PL	FMP30-PL
Operating weight <sup>1)</sup>	kg	152	195	450	830
Capacity	l	37	50	120	270
Sustainability max.	t	1	1	2	4
Sust.- Rotary Engine max.	t	5	5	10	15
Dimension A	mm	670	705	1025	1210
Dimension B	mm	725	730	1085	1235
Dimension C	mm	610	610	905	1145
Dimension D	mm	900	970	1530	1935
Width E	mm	360	400	500	660
Number of teeth	Stck.	3	3	5	5
Closing max.	kN	18	20	37	60
Operating pressure max.	bar	250	250	350	350
Oil flow max.	l/min	30	22	40	60
Oper.- pressure rotator max.	bar	320	250	250	250
Oil flow rotator max.	l/min	20	20	28	48
Base machine weight	t	1-2	2-5	5-9	9-15

Specifications subject to change without notice. <sup>1)</sup> Operating Weight basic unit without turning unit and mounting plate.

WHERE EXPERIENCE COUNTS

## FRD MULTI-PURPOSE GRAB - FMP LARGE SERIES -

### DESIGN FEATURES

- Hydraulic rotator unit with heavy duty axial and radial bearings with rotating hydraulic motor
- Flat compact design. Hydraulic cylinders and ganging guidance completely protected inside the frame
- Cylinders with limit damping
- Self-hold valves at the cylinders prevent the unintentional opening of the grab
- Integrated mechanical opening and closing stoppers
- Wear-resistant bottom cutters and side plates of high strength fine-grain steel ( 400 HB )
- With ESCO-plug-in exchange knives
- Free oscillating grab design available

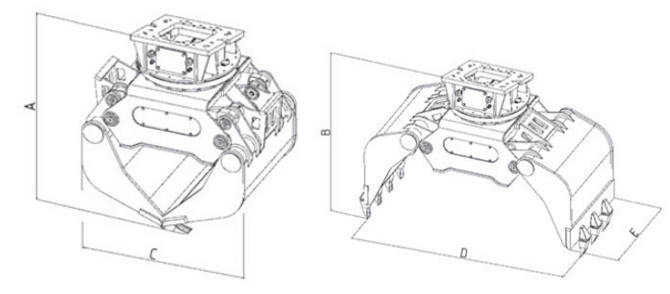

		FMP35-PL	FMP40-PL	FMP50-PL	FMP60-PL
Operating weight <sup>1)</sup>	kg	970	1665	1770	2200
Capacity	l	270	610	670	1025
Sustainability max.	t	4	6	6	8
Sust.- Rotary Engine max.	t	15	20	20	30
Dimension A	mm	1425	1630	1630	1940
Dimension B	mm	1450	1640	1640	1870
Dimension C	mm	1145	1330	1330	1500
Dimension D	mm	1935	2270	2270	2690
Width E	mm	660	940	1000	1030
Number of teeth	Stck.	5	7	7	7
Closing max.	kN	60	57	90	85
Operating pressure max.	bar	350	350	350	350
Oil flow max.	l/min	60	62	90	112
Oper.- pressure rotator max.	bar	120	140	140	140
Oil flow rotator max.	l/min	30	30	30	30
Base machine weight	t	15-20	16-22	23-30	29-40

Specifications subject to change without notice. <sup>1)</sup> Operating Weight basic unit without turning unit and mounting plate.

WHERE EXPERIENCE COUNTS